



air. × MicroClimate

Air3 Powered Air Purifying Respirator



CONTENTS

INTRODUCTION	2
PRODUCT DESCRIPTION	3
IMPORTANT NOTICE	3
LIMITATIONS OF USE	4
RESPIRATOR PROGRAM MANAGEMENT	4
NIOSH – APPROVAL, CAUTIONS & LIMITATIONS	5
TECHNICAL DATA & CRITICAL SPECIFICATIONS	6
ELECTRICAL SAFETY	7
ADDITIONAL PRECAUTIONS	8
ITEMS ENCLOSED	8
DESCRIPTION OF PARTS	9
ASSEMBLY, ADJUSTMENT & OPERATION	
- Visual Inspection	10
- Battery Charging	10
- Power Button	10
- Low Battery Warning	10
- LED & Buzzer Indicators	10
- Checking the Low Flow Warning	11
- Donning Procedure	12
MAINTENANCE & CARE	13
- AIR3 Cleaning	13
- Charger Cleaning	13
- Storage & Transportation	13
WARRANTY SECTION	14
BASIC TROUBLESHOOTING	15
REPLACEMENT SPARE PARTS	16
- Shroud	16
- Visor	17
- Filters	18
- Headgear & Headgear Fairing	19
ENVIRONMENTAL PROTECTION	19

INTRODUCTION

When used in accordance with its NIOSH approval, Air3 provides respiratory protection against particulates.

AIR3 does not provide protection against vapors or gases and is not an intrinsically safe system. See NIOSH Approval section of this User Instruction for additional information on approvals.

AIR3 is powered by an internal lithium-ion battery and provides a constant flow of filtered air into the respirator chassis. A shroud with a neck seal ensures that positive pressure is maintained in the respirator.

AIR3 has adjustable headgear ensuring to accommodate most head sizes.

Read this manual before using AIR3. MicroClimate respirators must be used in accordance with this manual to achieve the designed performance. The following symbols are used throughout this manual:



Denotes risk of personal injury, loss of life or damage to the tool in case of nonobservance of the instructions in this manual.



Denotes risk of electric shock.



Caution

Carefully read through this entire instruction manual before using the new AIR3. Pay close attention to the Safety section and the Safety Symbols.

Product Description

The MicroClimate™ AIR3™ Powered Air Purifying Respirator (PAPR) constitutes a complete National Institute of Occupational Safety and Health (NIOSH) approved respiratory system. When used in accordance with its NIOSH approval, AIR3 PAPR helps provide respiratory protection against particulates. **The AIR3 PAPR does not provide protection against vapors or gases and is not an intrinsically safe system.** See NIOSH Approval section of this User Instruction for additional information on approvals.

The AIR3 PAPR consists of a Visor, Shroud, Headgear, Fairing, two high efficiency filters, and a base assembly. The blower in the base assembly draws ambient air through high efficiency filters and supplies filtered air to the user. Should the airflow fall below the minimum design flow rate, an audible alarm will sound and the LED will change to yellow to warn the user to immediately leave the contaminated environment. Similarly, an audible and visual low battery alarm will activate when the battery pack has approximately 10-15 minutes of charge remaining to warn the user to leave the contaminated area.

Consult the Listing of Components, Accessories, and Replacement Parts in this User Instruction for additional information including a listing of AIR3 part numbers.

AIR3 must be used strictly in accordance with these instructions.

Only use AIR3 with the parts and accessories listed in these instructions.

AIR3 is only for use by trained, competent personnel.

In the powered-off state little or no respiratory protection is to be expected. In the powered-off state there may be a rapid buildup of carbon dioxide and depletion of oxygen.

Important Notice:

Shroud Fitment

Drawstrings should be tightened firmly against user's neck. Failure to cinch the draw strings sufficiently will compromise the neck seal. Without the neck seal, no respiratory protection is to be expected. Misuse of respirators may result in overexposure to contaminants and lead to sickness or death (see Fig. 7a & Fig. 7b, page 12).

Visor Fitment

When replacing filters or the visor, it is important to ensure that the visor is properly seated flat against the respirator base. To retain the previous alignment, grasp the visor with one hand and press it down to compress the foam while inserting the filter with the other hand (Fig. 4d, page 11). Special care should be taken to verify that the visor is seated flat to the respirator base between the locator tabs at the top of the respirator (see Fig. 12a & 12b, page 18).

Filter Installation

Before donning or transporting AIR3, ensure both filters are snapped into respirator base securely. Failure to do so may result in the filters and visor to fall out when being handled—potentially damaging and compromising their integrity.

Powering On: Press and Hold

Before donning AIR3, ensure the blower is running by pressing and holding the power button until the LED turns white and the respirator beeps once.

Proper Handling: Never Hold by Shroud

When handling or donning AIR3, ensure you are always grasping the base or head gear of the respirator. Never hold AIR3 by the shroud as it may detach from the respirator causing it to fall potentially damaging and compromising the respirator's integrity.

Leave the contaminated area immediately if any of the following conditions apply:

- The alarm sounds.
- Any part of AIR3 becomes damaged.
- Airflow into AIR3 decreases or stops.
- Breathing becomes difficult.
- Dizziness or other physical distress or irritation occurs.
- The user tastes contaminants.

Never modify or alter this product, except as directed in the service tasks contained within these instructions.

Head Protection: This is NOT an industrial safety helmet.

AIR3 comes with a solid headgear shell to provide lightweight head coverage from dirt, debris, and overspray as well as minimal head protection from contact with stationary objects (i.e. "bump" protection).

Limitations of Use

Do not wear this respirator system to enter areas where:

- ° Atmospheres are oxygen deficient;
- ° Contaminant concentrations are unknown;
- ° Contaminant concentrations are Immediately Dangerous to Life or Health (IDLH);
- ° Contaminant concentrations exceed the maximum use concentration (MUC) determined using the Assigned Protection Factor (APF) for the specific respirator system or the APF mandated by specific government standards, whichever is lower.

Immediately exit the contaminated area if any of the low battery or low airflow alarms activate. Refer to the User Instructions and the additional cautions and limitations under the NIOSH Cautions and Limitations in these User Instructions.

Respirator Program Management

Occupational use of respirators must be in compliance with applicable health and safety standards. By United States regulation employers must establish a written respirator protection program meeting the requirements of the Occupational Safety and Health Administration (OSHA) Respiratory Protection standard 29 CFR 1910.134 and any applicable OSHA substance specific standards. For additional information on this standard contact OSHA at www.OSHA.gov. In Canada, CSA standard Z94.4 requirements must be met and/or requirements of the applicable jurisdiction as appropriate. The major sections of 29 CFR 1910.134 are listed here for reference. Consult an industrial hygienist with questions concerning the applicability of these products to your job requirements.

Major Sections of OSHA 29 CFR 1910.134

Section	Description
A	Permissible Practice
B	Definitions
C	Respiratory Protection Program
D	Selection of Respirators
E	Medical Evaluation
F	Fit Testing
G	Use of Respirators
H	Maintenance and Care of Respirators
I	Breathing Air Quality and Use
J	Identification of Cartridges, Filters, and Canisters
K	Training and Information
L	Program Evaluation
M	Record keeping

NIOSH – Approval, Cautions & Limitations

The Microclimate™ AIR3™ Powered Air Purifying Respirator Assembly is a NIOSH approved respiratory system. Refer to the User Instructions and/or the NIOSH approval label provided with the AIR3 for a listing of components that can be used to assemble a complete NIOSH approved respirator system. The visor is Z87+ certified.

NIOSH Cautions and Limitations

A - Not for use in atmospheres containing less than 19.5 percent oxygen.

B - Not for use in atmospheres immediately dangerous to life or health.

C - Do not exceed maximum use concentrations established by regulatory standards.

F - Do not use powered air-purifying respirators if airflow is less than four cfm (115 lpm) for tight fitting facepieces or six cfm (170 lpm) for hoods and/or helmets.

I - Contains electrical parts that may cause an ignition in flammable or explosive atmospheres.

J - Failure to properly use and maintain this product could result in injury or death.

L - Follow the manufacturer's User's Instructions for changing cartridges, canister and/or filters.

M - All approved respirators shall be selected, fitted, used, and maintained in accordance with MSHA, OSHA, and other applicable regulations.

N - Never substitute, modify, add, or omit parts. Use only exact replacement parts in the configuration as specified by the manufacturer.

O - Refer to User's Instructions, and/or maintenance manuals for information on use and maintenance of these respirators.

P - NIOSH does not evaluate respirators for use as surgical masks.

Warning

Using AIR3 in environments with harmful vapors or fumes may result in sickness or death. AIR3 filters will not protect the lungs against harmful vapors or toxic fumes. Misuse may result in sickness or death. For proper use, read the instruction manual.

Transportation

For transportation purposes use the carry case provided and protect the unit from physical or chemical damage.



Please read the operating instructions carefully.



Not to be used if the contaminate is potentially explosive or highly flammable.

TECHNICAL DATA & CRITICAL SPECIFICATIONS

Head size: Protection factor: Blower sound level: Weight: Temperature range: Airflow: Humidity: Pressure:	20 1/2" to 25 1/2" (52 – 64.5 cm) Assigned (APF) 25 70 dB 3.17 lbs. nominal (1.44 kg) Charging +41°F to +104°F (5°C to 40°C) Use -23°F to +104°F (-10°C to 40°C) Storage +41°F to +104°F (5°C to 40°C) Initial Setting = 7 ft ³ /min (200 liters/min) Min Design Flow = 6.2 ft ³ /min (175 liters/min) 0-90% non-condensing for storage and use (Store out of direct sunlight) Storage 0.8 bars to 1.3 bars (0.78 atm to 1.2 atm) (11.6 psi to 18.9 psi) Use 0.8 bars to 1.3 bars (0.78 atm to 1.2 atm) (11.6 psi to 18.9 psi)
Battery Type: Nominal Voltage: Capacity: Battery life: Charging: Method/rate: Minimum for charging: Minimum for charging while operating:	Lithium-ion 3.7 Volts 13.2 Ah, 49 Whr. 8 hours, (fully charged). 5V, 2.1A 8 hours from fully discharged. 5 Volts, 1.0 Amp 5 Volts, 2.1 Amp
Visor Thickness: Material type:	2.1 mm Polycarbonate. Impact- and weather-resistant.
Filters	High Efficiency Particulate Filter (HE)

ELECTRICAL SAFETY



If the front cover is cracked or damaged, do not insert charger. There is a danger of electric shock.

Do not expose the charger to rain or snow.

To reduce the risk of damage to the charging port, pull the charger cord perpendicular to the connection when disconnecting charger from respirator. Ensure the cord is located so that it will not be stepped on, tripped over, or otherwise subjected to damage or stress.

Do not charge AIR3 with damaged cord or wall charger.

Do not attempt to charge unit if it has received a sharp blow, been dropped, or otherwise damaged in any way.

Do not disassemble respirator, except as directed in these instructions.

To reduce risk of electric shock, unplug charger from outlet before attempting any cleaning.



Safety Instructions for Battery Management

The internal battery is not fully charged when first purchased. Please read the safety instructions below, then follow charging notes and procedures.

Do not incinerate the batteries even if they are severely damaged or are completely worn out.
The battery can explode in a fire.

If battery leakage occurs and the outer seal is broken, and this leakage gets on the skin:

- a. Wash quickly with soap and water.
- b. Neutralize with a mild acid such as lemon juice or vinegar.

- c. If battery liquid gets into the eyes, flush them with clean water for a minimum of 10 minutes and seek immediate medical attention.

Never attempt to disassemble the respirator, except as directed in these instructions. If the plastic housing of the respirator breaks or cracks, immediately discontinue use and do not recharge it.

Do not charge the unit in a damp or wet environment.

Longest life and best performance can be obtained if the device is charged when the air temperature is between 64.5°F and 75°F. DO NOT charge the batteries in an air temperature below 41°F, or above 104°F. It will prevent serious damage to the batteries.

The front cover may become warm to touch while charging. This is a normal condition and does not indicate a problem.

Do not charge near heat sources.

DO NOT CONTINUE to use the respirator if the batteries do not charge properly.

Do not freeze or immerse the respirator in water or any other liquid.



Do not allow any liquid to get inside the charging port.



Never attempt to open the back or front cover for any reason. If the back or front cover breaks or cracks, do not use the device.

ADDITIONAL SAFETY



PRECAUTIONS FOR AIR3

Protective Equipment should be stored in a cool dry place.

To clean follow the instructions in this manual.

DO NOT apply paint, solvents, adhesives, or self-adhesive labels which are not approved by MicroClimate to the respirator.

DO NOT use AIR3 without filters installed.

DO NOT use AIR3 filters with damaged seals and/or damaged visor.

DO NOT use replacement parts except those supplied by MicroClimate.

To maintain the full efficiency of the AIR3, there must be no alteration to the structure or its component parts.

Toxic or contaminated residue on the AIR3 or the AIR3 filters from usage should be handled in a safe manner in accordance with your chemical or material suppliers' instructions. Used filters should be disposed of safely in the same manner.

If further information is required with regards to AIR3, please contact MicroClimate.



Charge the respirator before use. Ensure the AIR3 is assembled with the filters correctly installed. Ensure the shroud is correctly installed.

ITEMS ENCLOSED

1 x AIR3 complete unit

1 x Charger (A3A31)

1 x USB-c Cable (A3A32)

1 x USB-c Plug (A3A33)-----



1 x Blower Plug (A3A34)-----



1 x Carrying Case / Bag (A3A35)

1 x Microfiber cloth (A3A36)

1 x Wall Mount (A3A39)

2 x Wall Mount Screws (A3A40)

1 x Tear Off (A3A41)

Visit our website for tutorials and more useful information about AIR3: <https://microclimate.com>

DESCRIPTION OF MAJOR PARTS & ASSEMBLIES (COMPONENT DIAGRAM)

- | | | |
|----------------------------------|------------------------------------|---------------------------------|
| 1. Base SubAssy (P/N A3SA01) | 7. Headgear Support Rung | 13. Shroud Groove |
| 2. Front Cover with Electronics | 8. Headgear Screw (2 on each side) | 14. Drawstring (1 on each side) |
| 3. Back Cover with Blower inside | 9. Fairing SubAssy (P/N A3SA04) | 15. Filter Side A (P/N A3F15) |
| 4. Blower Outlet | 10. Fairing Screw (1 on each side) | 16. Filter Side B (P/N A3F16) |
| 5. Visor (P/N A3S04) | 11. Shroud (P/N A3S14) | 17. USB-c Charging Port |
| 6. Headgear SubAssy (P/N A3SA02) | 12. Shroud Safety Band | 18. Power Button |

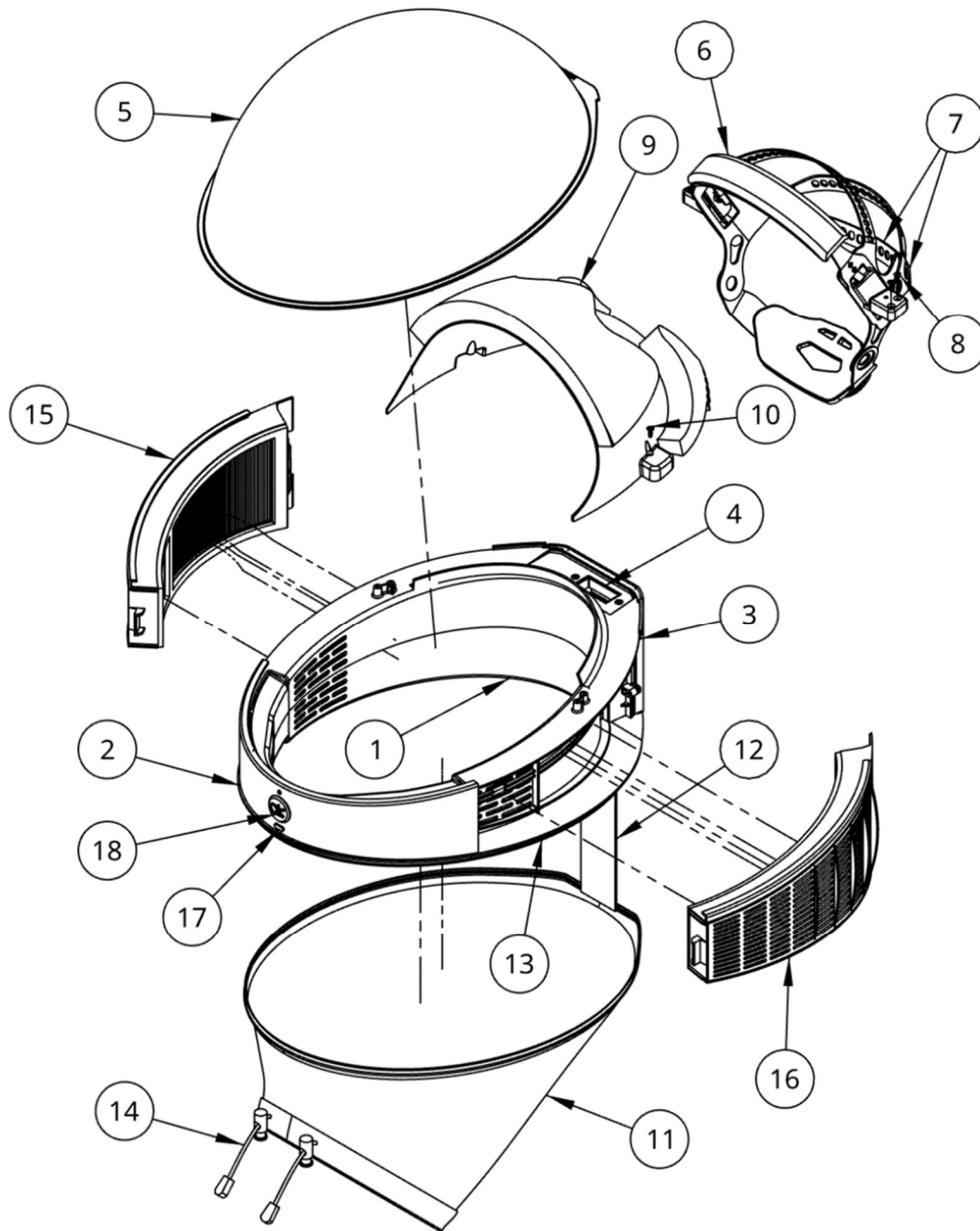

ASSEMBLY, ADJUSTMENT & OPERATION



Visual Inspection

Check the respirator for damage and verify it operates properly.

Check the shroud and its seams for damage.

Check the shroud seal is seated inside the base groove.

Check the visor and base for dents, scratches, or cracks.

Replace any damaged parts including scratched or damaged visors.



Battery Charging

AIR3 is shipped with a partial, but not full charge. For maximum initial operating time, make sure the device is fully charged before use. To charge the batteries, locate the USB-c charging connector and charge with a minimum of a 5-watt AC adapter.

When connected to auxiliary power, the respirator will beep to indicate connection, and beep again to indicate disconnection when removed. The LED pulses blue when it is properly connected and charging has begun. When battery charging is complete, the LED changes to green.

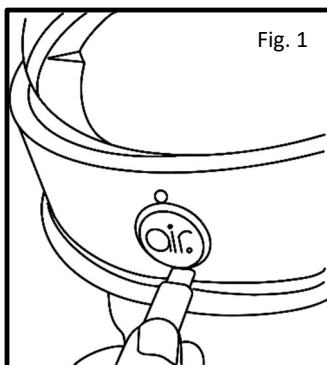

Power Button

The power button and charge port are on the front of the respirator. (Fig. 1). To power ON, press and hold the power button at the bottom of the respirator until you hear a beep. To power OFF, press and hold the button until the device beeps twice.



Low Battery Warning

When less than 10% of battery life remains an audible alarm will sound. The alarm will continue to sound every 5 minutes until the battery dies or a charger is connected. If the low battery alarm sounds, leave the contaminated area and recharge the battery. Alternatively, AIR3 can be plugged into an external power source while being worn as long as the output of the charger is at least 2 amp.

LED & Buzzer Indicators

- White = ON, operation as normal.
- Blue = Charging or operating & charging.
 - When charger connects or disconnects the respirator will beep once for charging and once when disconnected.
- Green = Fully charged.
- Yellow = Low flow alarm, alarm sounding.
- Red = Low battery. Alarm will sound twice every five minutes.

Checking the Low Flow Warning

The purpose of this test is to provide the user with a means for checking the functionality of the low flow warning alarm. The alarm should sound if airflow falls below 170 liters per minute.

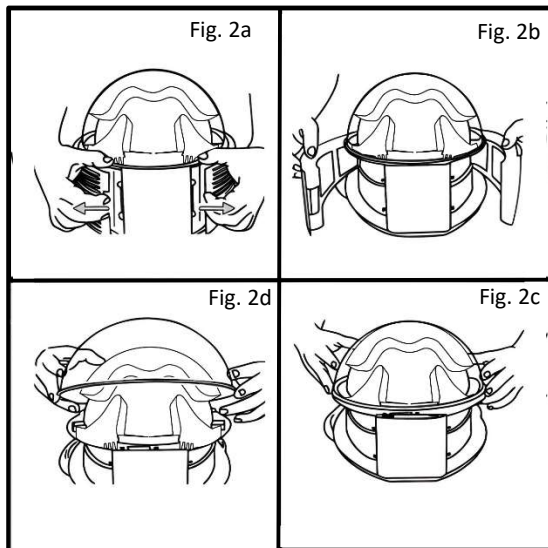

Remove both filters. The shroud may remain installed (Fig. 2a & Fig. 2b). Slide the visor up and back to remove it (Fig. 2c & Fig. 2d). The blower outlet is in the back of the base (#4 on component diagram).

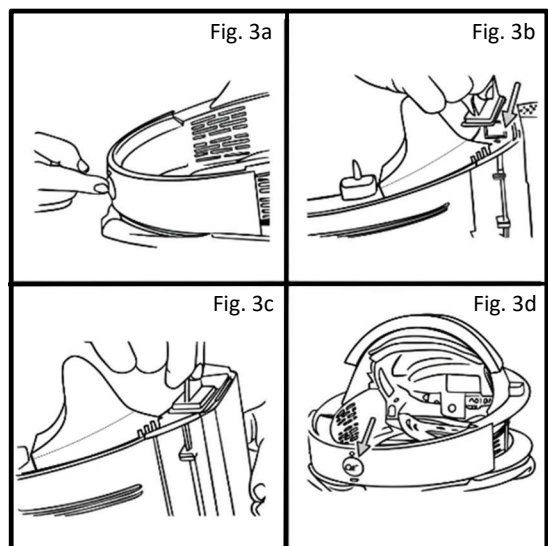

Turn on AIR3 by pressing and holding the power button until it beeps once and LED changes to white (Fig. 3a). Take the blower plug (A3A34) from the accessories bag. Cover and hold the blower plug on the top of blower outlet (Fig. 3b & Fig. 3c). After a few seconds the alarm will sound (Fig. 3d), this indicates the low flow warning device is functioning properly. Removing the blower plug should stop the alarm.

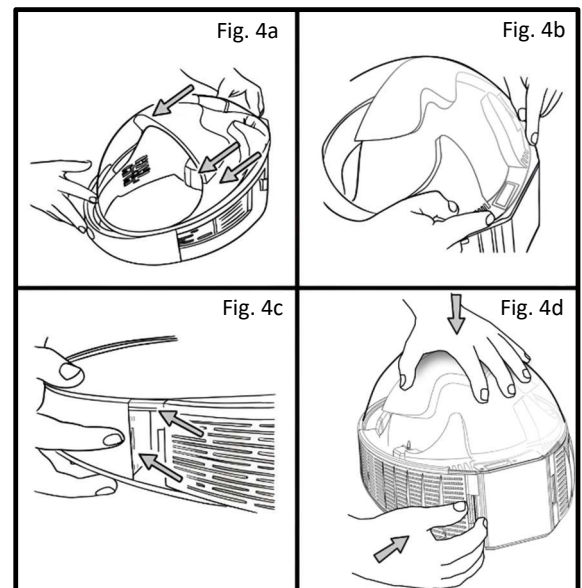

Ensure that the AIR3 is placed on a flat surface or table to facilitate the installation of the visor and filters. Turn off the AIR3, then slide the visor into place on the top of the base (Fig. 4a). Make sure the visor is flat against the sealing surface (Fig. 4b). Hold the visor and push down to compress the foam, while inserting the filter with the other hand. The flat edge of the visor should fit between the two base locator tabs. Finally, replace both filters (Fig. 4c & Fig. 4d).



Donning Procedure

AIR3 headgear may be adjusted to fit your head comfortably.

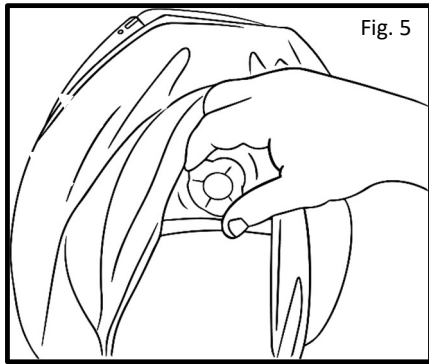

To tighten the headgear, twist the ratchet clockwise. To loosen, twist the ratchet counterclockwise (Fig. 5).

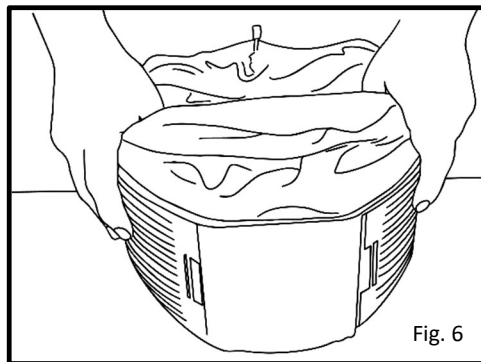

To don AIR3, grasp the respirator by the rim and hold AIR3 in front of you. The bottom of AIR3 should face you with the visor pointing down. Open the shroud wide with your thumbs (Fig. 6). Guide the respirator over your head. Adjust the headgear until it cradles the head firmly but comfortably.

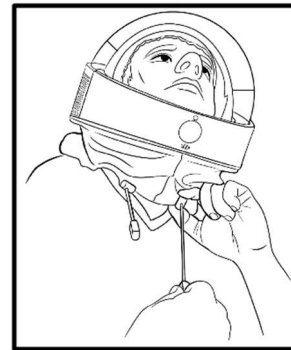
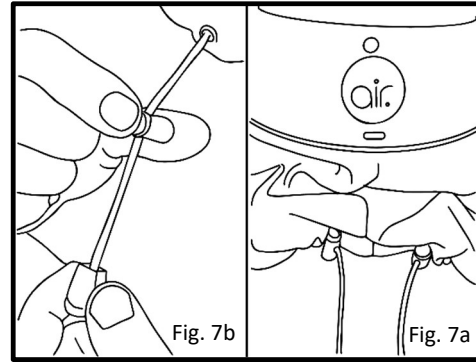

To create the seal around the neck, pull the two drawstrings at the bottom of the shroud until the shroud is snug against the neck (Fig. 7a & Fig. 7b).

See instructional video at <https://microclimate.com>.

MAINTENANCE AND CARE

AIR3 Cleaning

After using AIR3, follow the procedure below to clean: Carefully remove any bulk contamination from AIR3 and wipe down all surfaces with a damp microfiber cloth containing a mild, pH neutral detergent solution. Non-alcoholic wipes impregnated with bactericidal solutions are also recommended.



Precautions are to be taken to prevent inhalation of harmful dust or contaminant retained on the filters.

Clean and sterilize all parts by wiping down the outside of the visor, base, covers and headgear with wipes.

Do not immerse AIR3 in water or any other fluids. Do not use organic solvents or strong acid or base cleaning agents on any part of the equipment.



AIR3 should not be cleaned with compressed air, solvents, sterilized by heat, or autoclaving, as this will cause damage.

Gamma sterilization is effective but causes embrittlement of plastic components and is not recommended.

Replace if deficient after the following checks.

1. Excessive abrasion, scratches, or holes on the visor.
2. Broken shroud seal or fastenings.



Scratched or damaged visors may not offer full protection and therefore should be replaced.



Specific Instructions for Cleaning and Disinfection of Visor

Clean with a damp cloth (ideally made of microfibers or non-abrasive fabric). Do not use hydrocarbons, petroleum-based cleaners, alkaline cleaners, cleaning fluids, or solvents on the visor. If necessary, a mild solution of dish soap and warm water may be used. Make sure you rinse with water thoroughly. You can use a small amount of 70% ethyl alcohol or isopropyl alcohol sanitizer to disinfect the surface or a mild bleach solution, which should be left on for 1 minute and then rinsed with clean water on a microfiber cloth.

Specific Instructions for Cleaning and Disinfection of the Shroud.

Allergy Warning

The shroud is made of a polyester membrane with 100% polyurethane. Individuals with allergies to these materials should take necessary precautions.

Cleaning:

Clean the shroud using a mild solution of dish soap and warm water. Alternatively, it can be machine washed on a low setting.

Disinfection:

To disinfect, you may use a small amount of 70% ethyl alcohol or isopropyl alcohol sanitizer on the surface. A mild bleach solution can also be used; apply it to the surface and leave it for 1 minute before rinsing thoroughly with clean water, using a microfiber cloth.

Charger Cleaning

Dirt and grease may be removed from the exterior of the changing port using a cloth or soft non-metallic brush. Do not use water or any cleaning solutions.



Disconnect the USB charger from the connection before cleaning.

Lubrication

AIR3 requires no additional lubrication.

Storage

AIR3 should be placed in the carry case and stored within a temperature range of 41°F to 104°F out of direct sunlight.

Replacement filters are to be left in the sealed bags and expiry dates are to be checked regularly.

Transportation

AIR3 should be transported in the carry case provided. Good quality commercial packing should be used if packed in a box.

Warranty

MicroClimate warrants that AIR™ PAPR, and their component parts will be free from defective materials and workmanship at the time of purchase and will cover the parts listed below for the time periods indicated, provided they are maintained and used in accordance with the product's User Instructions and/or recommendations. MicroClimate's only obligation under this Warranty will be, at MicroClimate's option, to repair or replace without charge any defective parts of the AIR respirator product returned to MicroClimate in accordance with the instructions below and found by MicroClimate to have been defective at the time of purchase or during the warranty period as applicable. This Warranty does not apply to any parts that have been misused, altered or had repair attempted, or have been subjected to abuse, accidental or otherwise. The extended Warranty does not apply to expendable consumables, accessories, or fabric components such as but not limited to: filters/cartridges, shrouds, and visors.

Warranty time periods for specified parts:

- AIR3 PAPR, excluding consumables: 2000 hours of use or 1 year from date of purchase, whichever occurs sooner.

- Batteries: 250 cycles or 1 year from date of purchase, whichever occurs sooner.

- Battery charger cable and power supply, 1 year from date of purchase.

EXCLUSIONS TO WARRANTY: THIS WARRANTY IS EXCLUSIVE AND IS IN LIEU OF ANY IMPLIED WARRANTY OF MERCHANTABILITY, FITNESS FOR A PARTICULAR PURPOSE OR OTHER WARRANTY OF QUALITY, EXCEPT OF TITLE AND AGAINST PATENT INFRINGEMENT.

LIMITATION OF LIABILITY: Except as provided above, MicroClimate shall not be liable or responsible for any loss or damage, whether direct, indirect, incidental, special or consequential, arising out of sale, use or misuse of MicroClimate AIRs products, or the user's inability to use such products. THE REMEDIES SET FORTH HEREIN ARE EXCLUSIVE.

Basic Troubleshooting

Symptom	Cause	Remedy
Reduced Airflow / Low Flow Alarm Sounding	Filters clogged Fan outlet obstructed	Insert a new filter Assure fan outlet is unobstructed
No airflow	Unit switched OFF Batteries low or dead Electronics malfunction	Press to turn ON Recharge batteries See electronics malfunctioning below
Won't charge	Electronics malfunction	Please contact MicroClimate Customer Support at info@microclimate.com
Won't turn on		
Won't turn off		
Unstoppable beeping		
Run time diminished	Battery worn out	Contact MicroClimate
Visor is loose	Visor and filters are not seated correctly	Reset visor by lining up the base. Be sure that both filters are correctly installed, well clipped to the back cover base, and the corner lip of the filter is well inserted into the front cover base
Rattling or vibration noise	Fan contacting base	Please contact MicroClimate Customer Support at info@microclimate.com

Visit our website for more information: <https://microclimate.com/pages/faq-s>

REPLACEMENT OF SPARE PARTS

Only use replacement parts and accessories supplied by MicroClimate. The use of accessories not supplied by MicroClimate is not guaranteed and invalidates such National approvals as held by MicroClimate. Modifications to AIR3 will make approvals invalid and its use illegal under National Laws and Guidance. Do not use filters or other components of previous Microclimate models with AIR3. Previous model components such as AIR1 and AIR2 will not fit in AIR3 powered air purifying respirator, and without authentic AIR3 components no respiratory protection is to be expected.

MicroClimate replacement parts and accessories must only be used with Air products.

For more detailed instructions and visuals on proper care and how to install spare parts see the official MicroClimate website and tutorials.

Shroud

- To remove, undo the safety band, pull off shroud by starting at the bottom and pulling the shroud down out of the shroud groove (#11 on component diagram). Remove entirely.

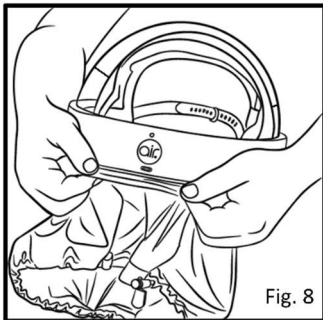

- To reinstall the shroud, with the respirator face down in your lap, line up the shroud seam with the power button at the bottom of the respirator (Fig. 8). Stretch the shroud in the groove at the bottom of the respirator and work the shroud slowly on either side of the respirator until you have stretched it around the entire opening of AIR3. Ensure the Shroud is seated in the groove all the way around the respirator.

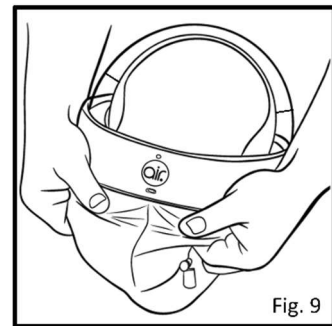

- Make sure the charging port is not covered and again, the shroud is seated inside the groove of the respirator base (Fig. 9).

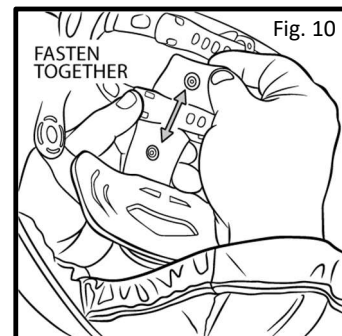

- Finally, fasten the snap on the safety band around the headgear support rung (Fig. 10).

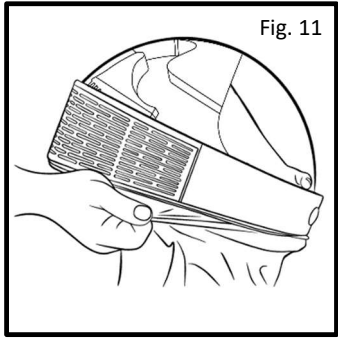

Fig. 11

- Check the fit by visually inspecting and touching that the seal edge is inside the groove (Fig. 11).

Visor

- To change the visor, ensure that the AIR3 is placed on a flat surface or table to facilitate the installation of the visor and filters. Remove the filters first. The shroud may remain installed (Fig. 2a & Fig. 2b, page 11).
- Slide the visor back over the base to completely remove it (Fig. 2c & Fig. 2d, page 11).
- To install a new visor, slide the circular part of the visor into the front of the base, and fit the flat part of the visor over the back cover. The square part of the visor should fit between the two base locator tabs (Fig. 4a & Fig 4b, page 11).

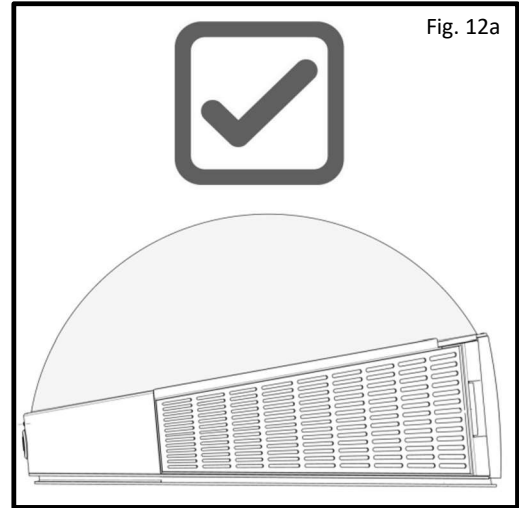

Fig. 12a

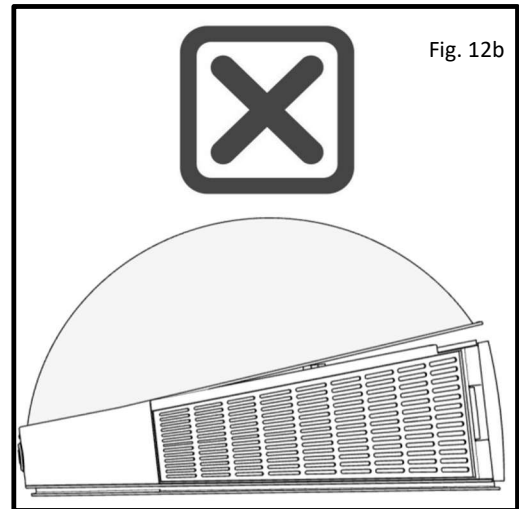

Fig. 12b

- Hold the visor and push down to compress the foam, while inserting the filter with the other hand. Reinsert the filters (Fig. 4c & Fig 4d, page 11). Only a fully seated visor can fit inside the filter flanges (Fig. 12a & 12b).

Filters.

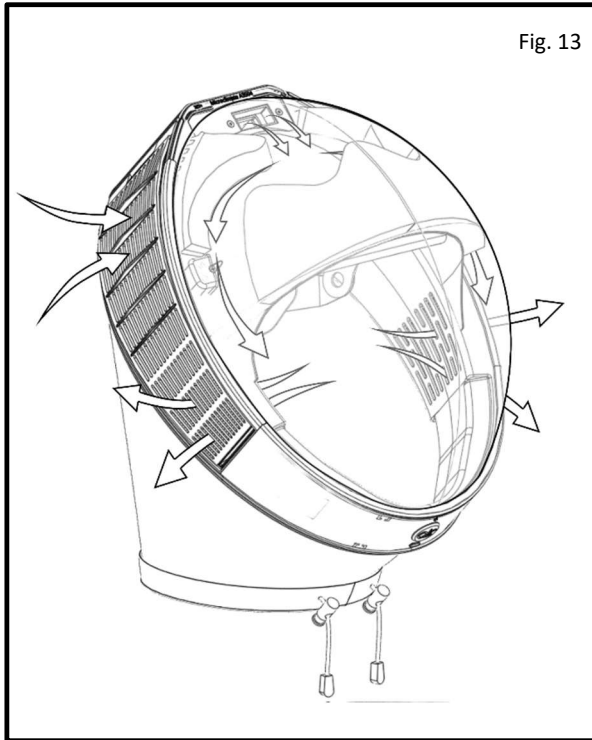

Fig. 13

- Unlike other Microclimate filters, each AIR3 filter is a compact combination of an inlet HE filtration section (larger area) and outlet filter section (Fig. 13). A spark arrestor is integrated into each filter.
- The end of the inlet section of each filter has a clip to couple to the base, and the end of the outlet portion has a tab that inserts into a slot in the base. The external portion of both filters has a black plastic grille for filter media protection.
- Filters must NOT be cleaned. Do not use compressed air or a brush to clean or blow out the filter. If dust becomes trapped in grill, filter may be gently tapped, such that dust drops out. Misuse of Microclimate AIR3 by cleaning the filter may result in overexposure

to contaminants and lead to sickness or death.

- Use only Microclimate AIR3 filters with the Microclimate AIR3 respirator. Use of other filters may result in overexposure to contaminants and lead to sickness or death.
- Change the filter if it is damaged, there is any suspicion of being damaged, or after the expiration date.

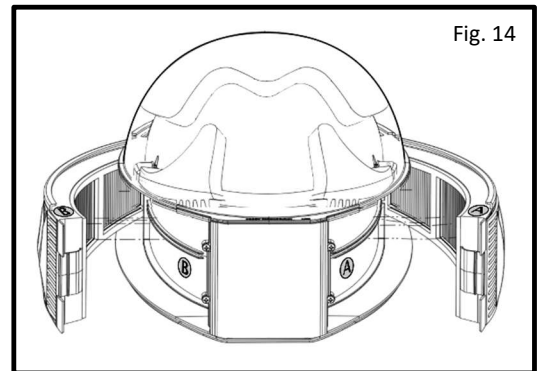
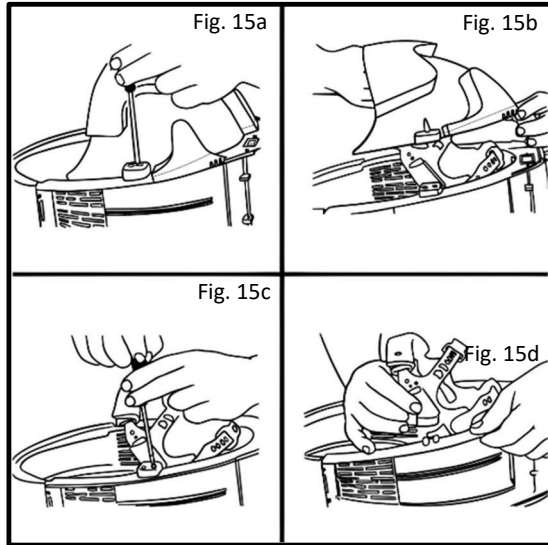

Fig. 14

- Filters are not interchangeable. Filter Side A (P/N A3F15) corresponds to the A side and label A, and the Filter Side B (P/N A3F16) corresponds to the B side and label B (Fig. 14).
- Frequency of filter replacement depends on use and usage location. Replace the filters if they become dirty or have physical damage.
- A blocked, clogged or heavily soiled inlet filter will trigger the low flow alarm (yellow LED light and 5 beeps per second). This alarm indicates that the flowrate is under the minimum designed flowrate.
- To change the filter, unclip the filter from the back cover and remove the filter side inserted into the front cover (Fig. 2a & Fig. 2b, page 11).
- To insert the new filter, start by inserting the tab of the filter into the base slot. Then, clip the filter to the back cover by firmly pressing each filter with your thumb on the clip, until it clicks into place. (Fig. 4c & Fig 4d, page 11).

Headgear & Headgear Fairing

- If the headgear needs to be changed, follow the steps below.
- Remove the filter first. Remove the visor by sliding it back over the surface base (Fig. 2a to Fig. 2d, page 11).



- Remove the headgear fairing with a Phillips screwdriver by unscrewing the single small screw at each side (Fig. 15a & Fig 15b).
- Remove the headgear by unscrewing the two small screws at each side (Fig. 15c & Fig 15d).
- Reinstall the headgear fairing by inserting and fastening a screw at each side. (Do not overtighten)
- Reinstall the visor and filters.

Visit our website for more information about how to replace filters, shroud, visor, and headgear:
<https://microclimate.com/pages/tutorials>

ENVIRONMENTAL PROTECTION

Recycle raw materials where possible instead of disposing as waste.

Accessories and packaging should be sorted for environmentally friendly recycling.



Separate collection. This product must not be disposed of with normal household waste.

Electronic Components and the Environment



Electronic components can be recycled, but only at permitted treatment facilities. When discarding AIR3, it must be disposed of at **an authorized household e-waste collection point location**.

DO NOT THROW AWAY WITH YOUR HOUSEHOLD WASTE.

They may end up in an incinerator or landfill, which must be avoided.

MicroClimate inc.
3500 S. Mountain Vista Pkwy,
Provo, UT 84606
Tel: (801) 823-1884
info@microclimate.com
www.microclimate.com
User Instructions Rev g

© Copyright MicroClimate 2024 No part of this publication may be reproduced, stored or transmitted in any form without prior permission.
MicroClimate cannot be held liable for any material rendered unusable or any form of consequential loss. E&OE *All trademarks acknowledge